

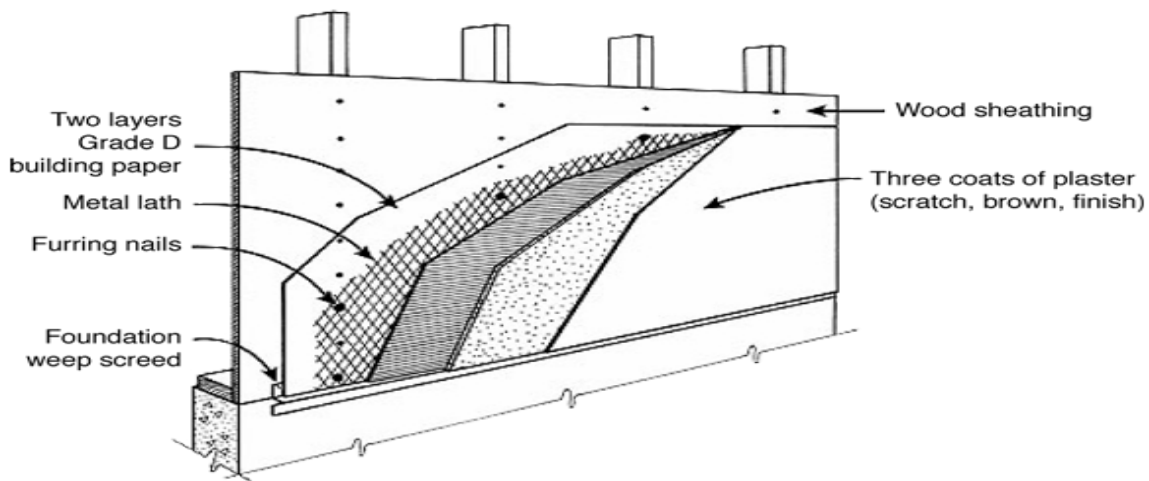

**Nassau County Building Department**  
96161 Nassau Place  
Yulee, Florida 32097

# All Contractor's and Inspectors **Are invited to attend** Stucco Workshop

- Application methods over wood and masonry
- Lath, accessory and control joints
- Recommended practices



Held on: Friday, July 22, 2016 at 8:00 am until 10:00 am

Held at: Nassau County - James Page Building  
96135 Nassau Place, Yulee, FL 32097

Presentation given by: G. Michael Starks, In-Spex

**August 22, 2016 Nassau County will require an inspection to be made for the installation of exterior lath for all stucco installations as required by the Florida Building Code.**

**FERNANDINA**  
**(904) 530-6250**

**TOLL FREE**  
**1-800-948-3364**

**FAX**  
**(904) 321-5763**